

manifesting a new world in harmony with natural law

new earth retreats



HUMANITAD

NEW EARTH RETREATS

New Earth Retreats will act as worldwide hubs and catalyst for ecological and conscious living. They will host:

- 1) World-class **Wellness Spas** combining multi-disciplinary healing treatments facilitated by **Ayurvedic Centres** managed by vedic master and President of the International Ayurvedic Foundation Doctor Vaidyaratnam Raghavan.
- 2) A **New Earth Institute** serving as a global focus venue for learning and creative expression. The Institute will host international symposia, workshops, training camps, seminars, congresses and retreats in all disciplines.
- 2) A **New Earth Estate** providing the world's first real-estate model offering buyers zero-running costs (for life).
- 3) Exemplary **Ethno-botanical Gardens** with restaurant, cafe and health juice bars as unique venues for local and international visitors alike.

Specific project deliverables include the capacity to:

- ◆ **CREATE** energy independence throughout the infrastructure, design and realization of the Project.
- ◆ **PROVIDE** full-spectrum sustainability - providing all energy, water, waste processing, food, construction and education as part of a comprehensive design solution which remediates and restores the local eco-system to its natural state.
- ◆ **IMPLEMENT** a comprehensive permaculture strategy to service food and organic productivity needs.

New Earth Retreats and the New Earth Institute will lead the world in R&D of conscious development, new sciences, health & wellness and new economics. The international programme will also define a new model for conscious eco-tourism. Humanitad is currently establishing phase-one projects in Bali, Samoa, Hawaii, Mexico and Costa Rica.

The New Earth Project is manifesting a 'new-earth' template for the rest of the world to observe and emulate.





- ◆ Utilising proprietary New Earth Bio-architecture
- ◆ Pioneering ecological-retreat
- ◆ Designed by world-leading architectural & permaculture experts
- ◆ Inspirational landscaping and bio-diversification
- ◆ Sustainable zero-impact lifestyles
- ◆ World-class international cuisine, restaurants and cafes



The Development Approach....

new earth project



New Earth Institute

- ◆ Breakthrough Science & Tech
- ◆ New Earth Economics
- ◆ Healing & Wellness
- ◆ Spiritual Advancement Studies
- ◆ Sacred Arts & Sciences
- ◆ Permaculture & Husbandry
- ◆ Vedic Arts
- ◆ Yoga & Meditation
- ◆ Ethnobotany & Earth Medicine

The New Earth Institute will quickly become a global focus platform for higher learning & creative expression. It will facilitate international partner organizations dedicated to ushering in the new earth and host international symposia, workshops, training camps, seminars, congresses and retreats.

The Institute will house faculties designed to facilitate key disciplines across academic, spiritual and creative expression and enquiry.



New Earth Estate

- ◆ Zero-point micro grid
- ◆ Optional cash-less lifestyle
- ◆ Healing & Wellness
- ◆ Locally grown organic foods
- ◆ Orgone protected infrastructure
- ◆ Structured-water supply
- ◆ 100% eco waste management

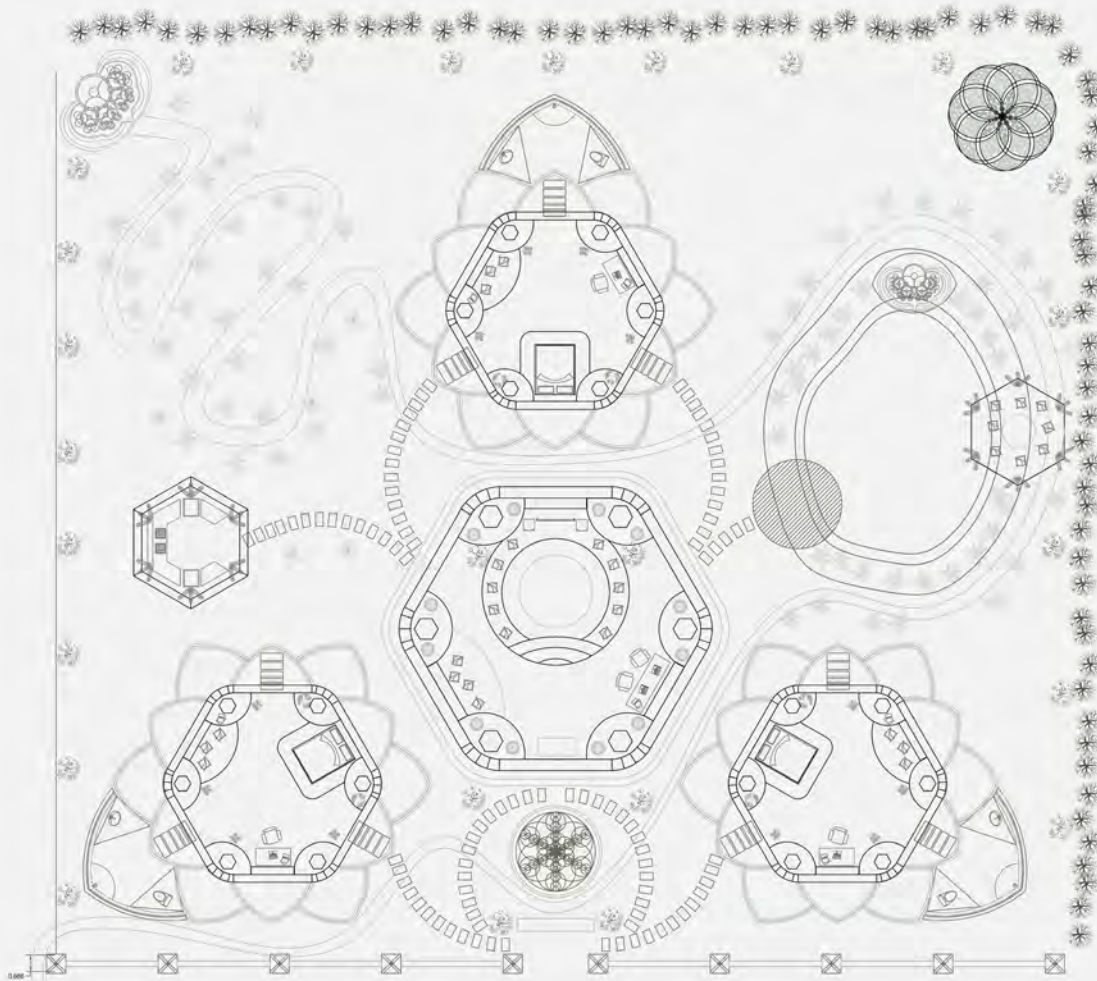

New Earth Estate residents will enjoy a ground-breaking model for live, work and play which releases them from the obligations associated with normal real-estate purchase: whilst also providing an environment and habitat which nurtures wellness, prosperity and spiritual upliftment.

new earth project

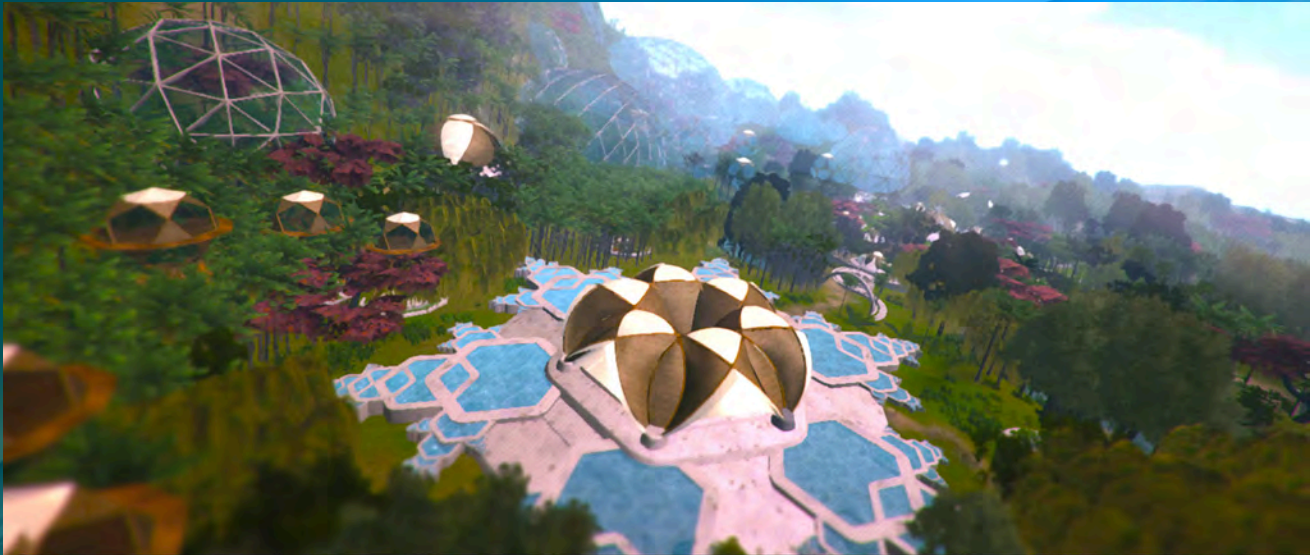
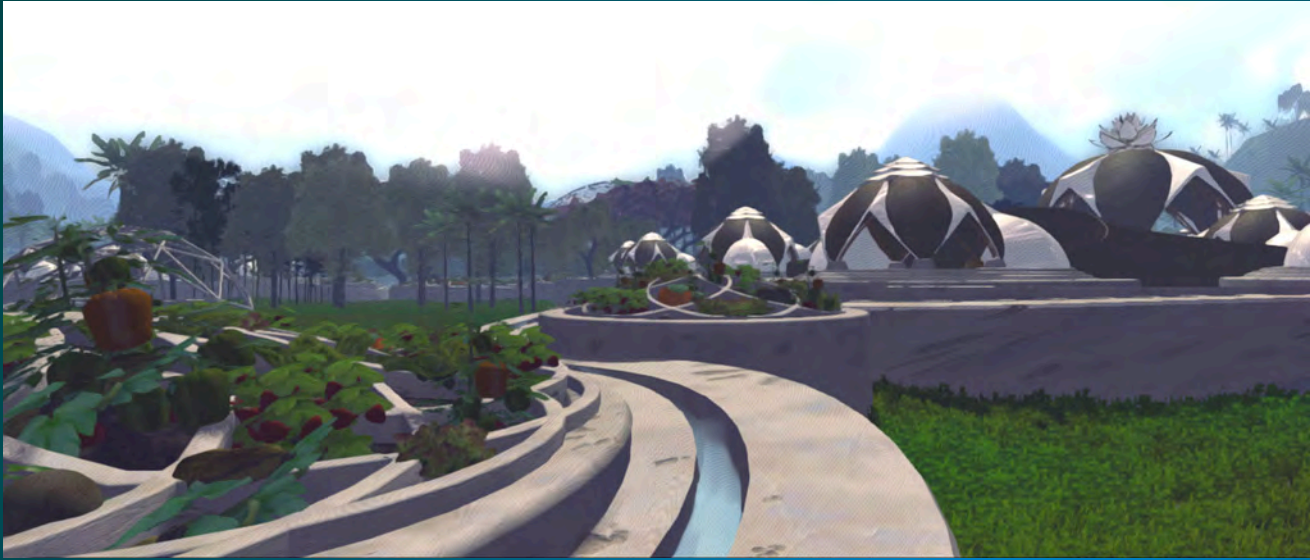

New Earth Farm

- ◆ Organic Ayurvedic Gardens
- ◆ Pesticide and GMO free
- ◆ Organic Farmers Markets
- ◆ Native Variety Seed Banks
- ◆ Water Purification
- ◆ Animal husbandry
- ◆ Global exemplars in full-spectrum sustainability



new earth project

THE NEW EARTH PROJECT DEVELOPMENT

New Earth Project design principles are based on the uncompromising and aesthetically perfect geometry of nature. The design of each structure and layout of the proposed development conforms to the same organising principles used by the natural world at the atomic, cellular and molecular levels to create all living things.

By honouring this natural order throughout our design philosophy, we create consciousness enhancing structures and developments which align with the design of the human form, thereby encouraging cellular regrowth and returning the human body to its natural, vibrant state.

This holistic approach to wellness and healing is no longer an abstract art. Modern doctoring and science is increasingly re-learning to embrace such ancient and foundational wisdom.

Humanity has fostered and promoted innovations and innovators in the area of health and wellness. The New Earth Project receives the benefit of the knowledge & technology transfer of this planetary network.

The New Earth Project is partnered by its sister organization Exemplar-Zero Initiative which provides the New Earth Retreats with breakthrough sustainable technologies and solutions in energy, building, waste management, water purification and food production.

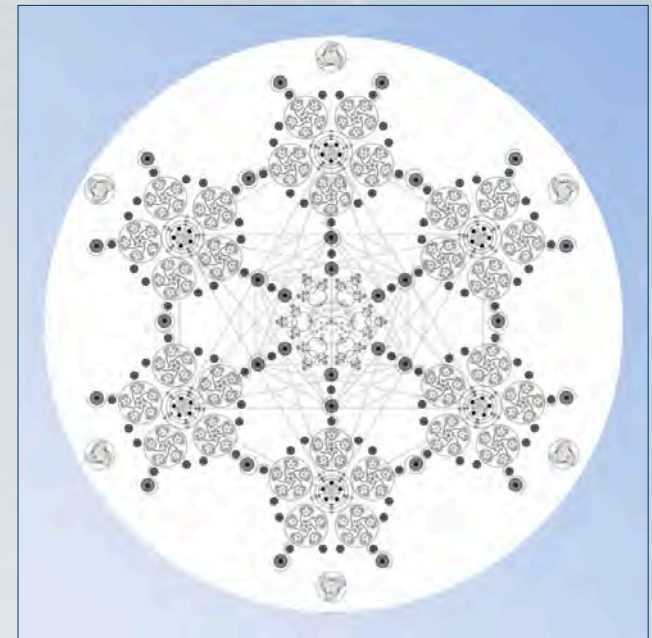

Retreat and Real Estate Generic Masterplan

- Community Spaces
- Plot Type A
- Plot Type B
- New Earth Institute
- Conference/workshop Centres
- Retreat Facilities & Clinics
- Retreat Accommodations

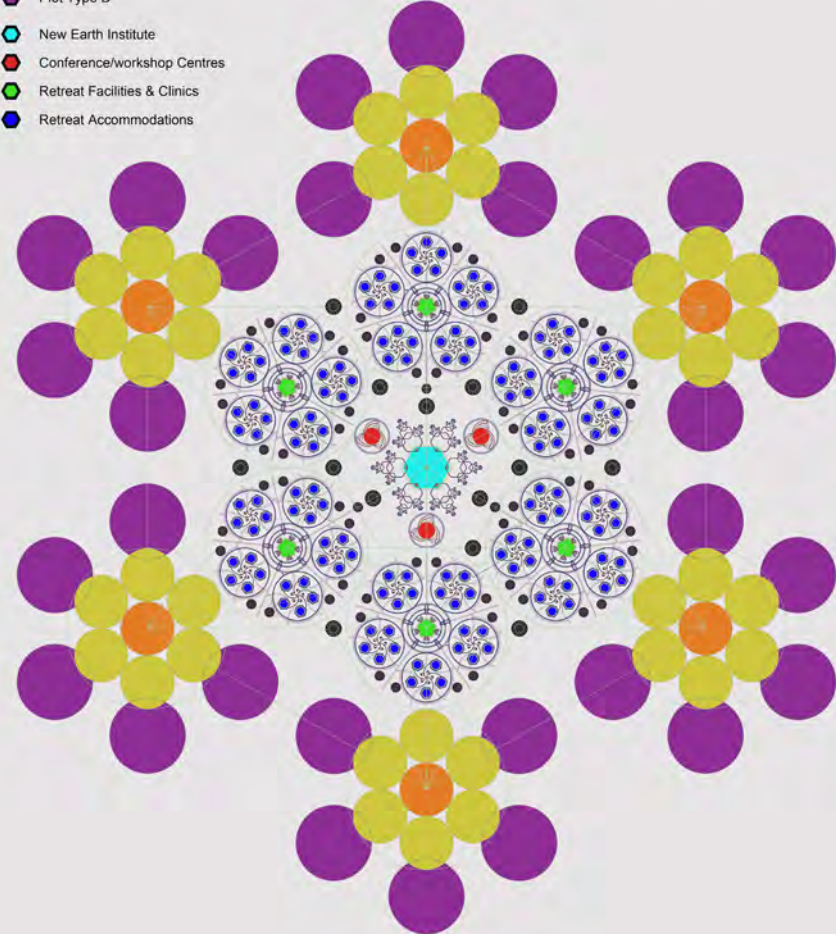

Retreat and Real Estate Generic Masterplan B

- New Earth Institute, Clinic, Restaurant
- Retreat Accommodations
- Real-estate Plots

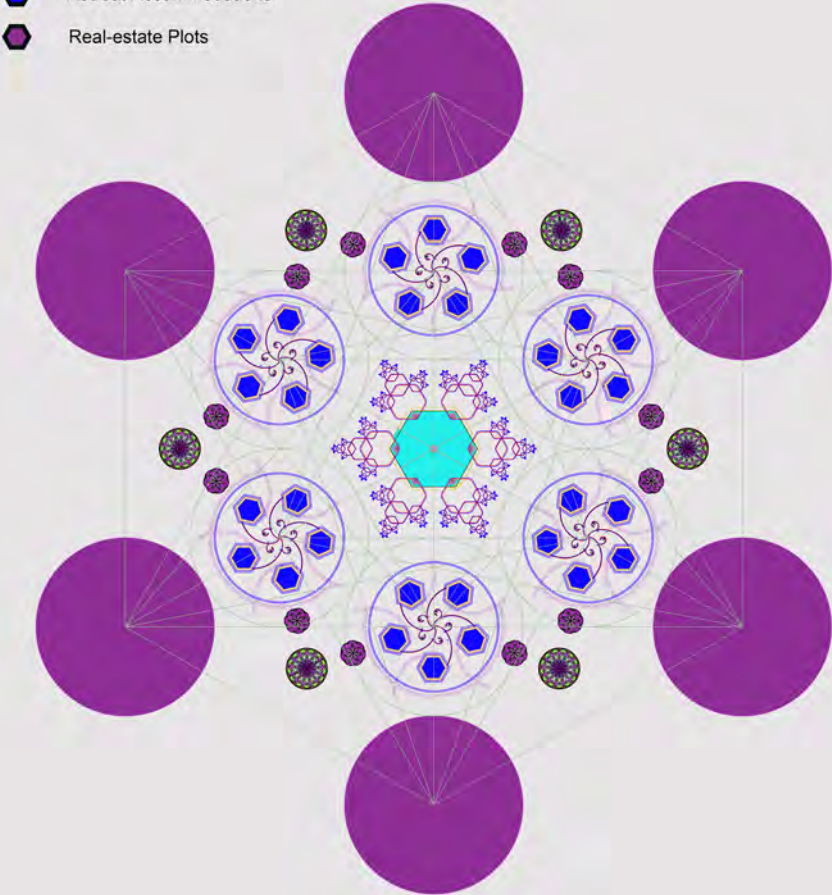

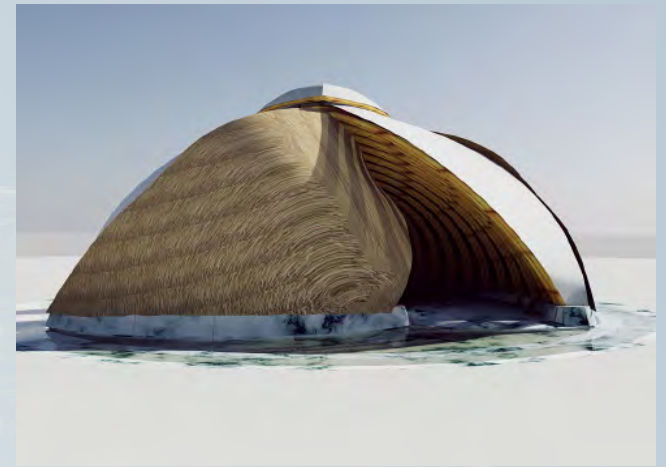

EXEMPLAR-ZERO BUILD

CONSTRUCTION MATERIALS

◆ **Geo-Polymer:** As a construction material, geo-polymers are well known as “green” building materials that provide communities with an indigenous and sustainable alternatives to Portland Cement. Buildings, roads, bridges and waterways constructed from geo-polymers possess far greater compressive and tensile strengths than Portland Cement, are fire-proof, water-proof, pest-proof and become stronger over time as they sequester CO2 from the atmosphere for decades. From a cost perspective, geo-polymers are less expensive to produce, do not require routine maintenance or replacement, and our E-Z Energy Technologies will be manufactured without adding additional CO2 to our atmosphere. For this reason, E-Z Geo-polymers manufactured locally will deliver a carbon-neutral effect globally, while our construction projects will deliver a carbon-negative effect locally.

◆ **Bamboo:** This great traditional building material is being revived for modern construction requirements. At the same time growing bamboo helps to create forests and retain rainwater raising ground water levels.

◆ **Binishells:** Binishells may be the greenest way to build ever invented. Using low air pressure to lift and shape reinforced concrete thin shell structures, poured at ground level, Binishells essentially use air as their form work. As well as being inherently green, Binishells are fast, strong and flexible and can be made in an infinite variety of shapes. They can be used for everything from high-end residential, to schools, to gymnasiums, commercial buildings, low cost housing, emergency shelters and an infinite variety of other typologies.

Green:	<i>reducing carbon footprints by approx. 80%</i>
Fast:	<i>reducing construction schedules by between 67% and 75%</i>
Strong:	<i>able to resist hurricanes, earthquakes and floods</i>
Flexible:	<i>infinite variety of shapes, uses and finishes</i>
Inexpensive:	<i>reducing construction costs by an average of 50%</i>



new earth project

EXEMPLAR-ZERO WATER

WATER PURIFICATION

- ◆ **E-Z Water Purification systems:** There are various E-Z water purification technologies available that range from state-of-the-art water desalination, sterilization, bacteria and virus elimination systems to naturally occurring effective microorganisms and vermicultures. Applications include improving drinking water supplies and lake & river remediation.
- ◆ **The Imploder Vortex Water Treatment:** The Imploder is a specially designed Vortex nozzle, which energizes any water back to its natural state, as it would come out of a mountain spring. Water treated with an Imploder is profoundly beneficial to all living beings. Many experiments have evidenced significant improvements to health, growth speed and nutritional content of plant life, in addition to the countless reports of improvements to human health, following prolonged use of this water.



EXEMPLAR-ZERO FOOD

FOOD PRODUCTION

- ◆ **Organic Agriculture:** Food and other agricultural products produced with permaculture principles and according to organic guidelines not using any chemical pollutants such as S.R.I.
- ◆ **Organic Domestic and Community Aquaponic Systems:** Redesign of existing Aquaponic systems and establishing new systems to achieve truly organic and non-polluting fish farming operations, eliminating the ongoing costs of chemical additives and eradicating pollution.



new earth project

EXEMPLAR-ZERO ENERGY

ELECTRICITY GENERATION

◆ **EZ Power Generators:** Exemplar Zero uses standard power generator systems, which normally consume diesel, petrol or natural gas and modifies them to run on water-extracted hydrogen, oxygen and plasma. This technology dramatically reduces energy generation and maintenance costs due to the fact that the engines run clean with only water steam as exhaust. This Exemplar-Zero technology is positioned as one of the leading breakthrough technologies within the E-Z Initiative. We continue to develop further variations on this water-based technology suited to both centralized and/ or decentralized power objectives.



EXEMPLAR-ZERO WASTE

WASTE WATER TREATMENT & RECYCLING

◆ **ABCC Municipal Waste & Waste-Water Treatment System:** a unique, proprietary way of converting municipal waste into energy. It is a clean trash-to-energy-to-food system. MSW, or trash, can be converted into a multitude of valuable commodities, many utilized in food production and food processing. It is a full-circle, full-cycle bio-mimcry system. The state-of-the-art processes include separation for recyclables, bio-digestion, bio-composting, vermiculture, algae-culture, closed looped reduction of inorganics, clean generation of electric power, and capturing and cleaning gases and fuels. The products include three highly-productive, organic, fertile top- soil amendments, clean electricity, a superior fish food and livestock feed supplement, blue green algae (Spirulina and Chlorella) for the food processing and health food industries and for pharmaceutical precursors, distilled water, and compressed food grade CO2 for the beverage industry. Food grade CO2 is used to brew beer, soft drinks, and to decaffeinate coffee and tea. It is in short supply. The topsoil amendments can significantly accelerate the regeneration of unproductive croplands. It takes 9 tons of petroleum to make 1 ton of pesticide, or herbicide. This is a huge waste of this resource. Most petrochemical products can be replaced by bio-products.



new earth project

NEW EARTH RETREAT DEVELOPMENTS

The retreat and institute facilities are positioned as exclusive resorts where patrons will be able to enjoy relaxation, educational and health oriented facilities whilst enjoying world-class ayurvedic food and beverages.

850m² Toroid Domes (see illustration) will serve as the facility for each of the New Earth Institutes. First floor spaces will house eco-pod style economy accommodation for 75+ visitors.

36m² Trishula Domes all offering a 5* luxury standard

130m² Lotus Domes housing Unication clinics, Ayurvedic Centres, New Earth restaurants and wellness spa facilities.



Toroid Dome

NEW EARTH PROJECT FACILITIES

- ◆ New Earth Institute
- ◆ Unication Clinics
- ◆ Ayurvedic Clinic
- ◆ International Cuisine restaurants
- ◆ Vedic Yoga & Meditation
- ◆ Raw Food Cafe & Juice Bars
- ◆ Ayurvedic Massage Spas
- ◆ Ethno-Botanical Gardens

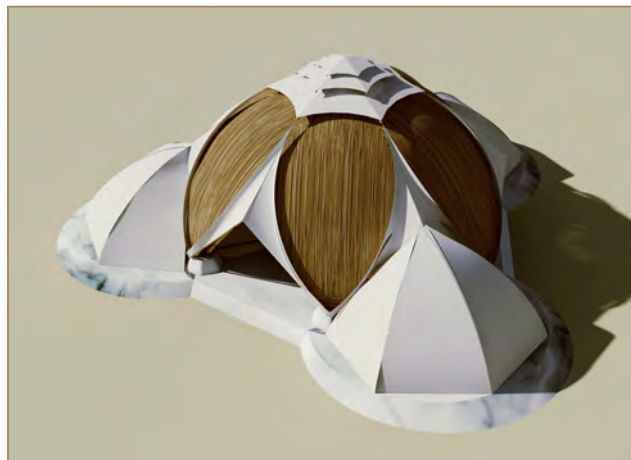

Trishula Dome

Lotus Dome

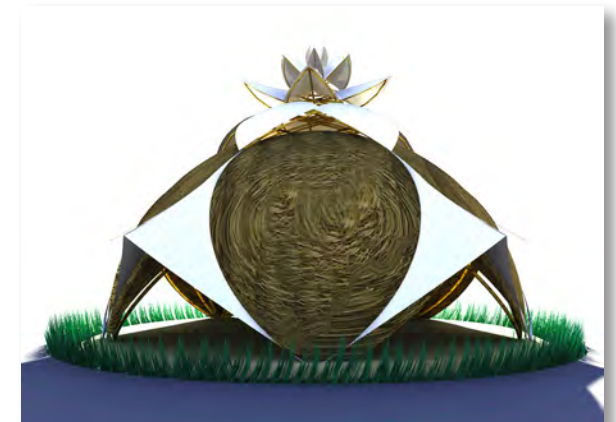

PROFIT SHARING MODEL

50% of net profits generated by New Earth Retreats will be distributed to its stakeholders as per the profit sharing model.

25% of net profits generated by New Earth Retreats will be deposited into a dedicated HUMANITAD LOCAL TRUST whose beneficiaries will be the local people.

25% percent of net profits generated by New Earth Retreats will be deposited into a dedicated NEW EARTH TRUST whose beneficiaries will be humankind and planet earth.

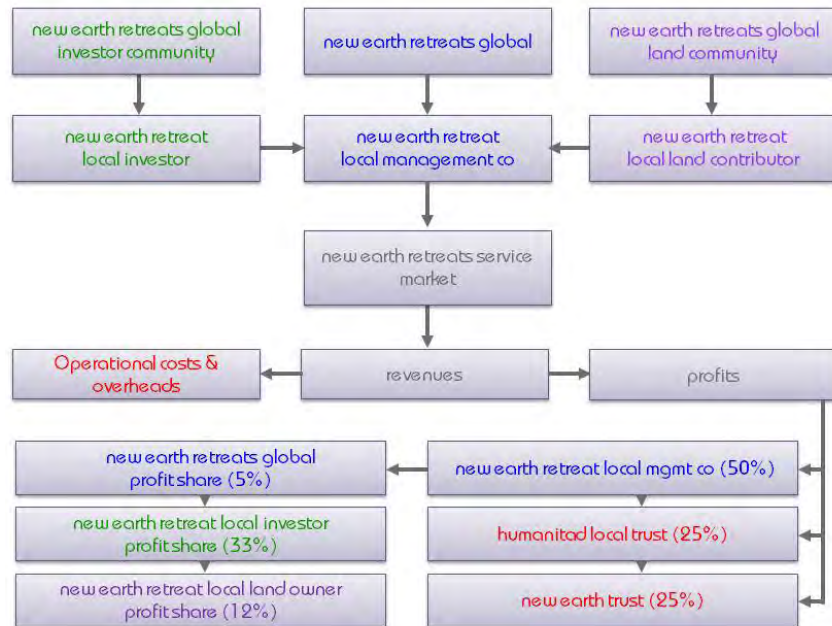

USE OF TRUST FUNDS

Funds held by both the HUMANITAD LOCAL TRUST and the NEW EARTH TRUST will be employed at their respective local and global levels to:

1. Advance the worldwide New Earth Project model by:

- Developing** additional New Earth Retreats to create a robust international network.
- Hosting** coordinated, annual, 5 day Festivals as a unified global focus event from the selected New Earth Project locations across the globe.
- Establishing** New Earth Cooperatives.
- Educating** peoples from local regions in the New Earth disciplines facilitated through the network of New Earth Institutes.
- Generating** new vocational opportunities in the New Earth disciplines across local regions.



Core Administration Team

- ◆ Sacha Stone: Founder
- ◆ Greg Paul: New Earth Project Director
- ◆ Greg Kheel: Program Director
- ◆ Frederik Stimmel: Exemplar Zero Technologies
- ◆ Putu Indra Suryatmaja: Humanitad Director
- ◆ Dr. Vaidyaratnam Raghavan : New Earth Ayurvedic Clinics
- ◆ Juan Schossler: New Earth Geo-Architecture & Masterplanning
- ◆ Ben Hayes: Creative Direction & I.T integration
- ◆ Dr. Dezso Benedek: Humanitad Culture & Education
- ◆ Bi Ma Anden: New Earth Schooling & Curricula
- ◆ Eric Willis: International New Earth Retreats Development
- ◆ Dana Stewart: E-Z Technology Integration
- ◆ Reinhold Ziegler: New Earth Built Environment
- ◆ Michael Rice: New Earth Bio Architecture
- ◆ John Barrie-Button: New Earth Permaculture

Strategic Partners

- ◆ **Synergy International, Inc**
- ◆ **ABCC** (*Alliance Bio Conversions Corporation*)
- ◆ **Bloom the Desert**
- ◆ **Exemplar Zero Initiative**

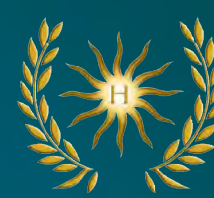

www.new-earth-project.org
www.humanitad.org
www.exemplar-zero.org
www.earth-sanctuary.org
www.nwo-igo.org



new earth project